

# 3-Button Handheld Remote Control



BEFORE USING THIS REMOTE CONTROL, REFER TO YOUR GARAGE DOOR OPENER'S INSTRUCTIONS FOR DETAILS ON ADDING A NEW REMOTE CONTROL

## HOW TO CHANGE THE REMOTE'S BATTERIES

IF THE RED LIGHT ON THE REMOTE GLOWS DIMLY, OR FAILS TO LIGHT WHEN A BUTTON IS PUSHED, REPLACE THE REMOTE'S BATTERIES

- ① REMOVE VISOR CLIP AND SCREW

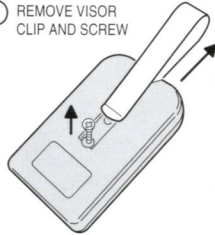

- ③ INSTALL TWO TYPE 2016 BATTERIES PLUS (+) SIDE DOWN

- ④ REASSEMBLE THE UNIT WHEN FINISHED

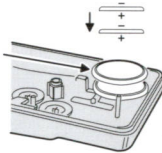

- ② CAREFULLY REMOVE THE CIRCUIT BOARD

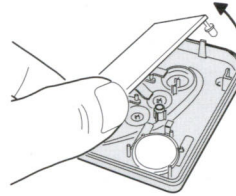

FCC NOTICE: CHANGES OR MODIFICATIONS NOT EXPRESSLY DESCRIBED IN THESE INSTRUCTIONS OR APPROVED BY THE MANUFACTURER COULD VOID THE USER'S AUTHORITY TO OPERATE THIS EQUIPMENT. THIS DEVICE COMPLIES WITH FCC PART 15 AND INDUSTRY CANADA RULES AND REGULATIONS. OPERATION IS SUBJECT TO THE FOLLOWING TWO CONDITIONS: (1.) THIS DEVICE MAY NOT CAUSE HARMFUL INTERFERENCE AND (2.) THIS DEVICE MUST ACCEPT ANY INTERFERENCE RECEIVED, INCLUDING INTERFERENCE THAT MAY CAUSE UNDESIRED OPERATION.

## LIMITED WARRANTY

Linear Corporation (the Company) warrants to the original purchaser that products delivered hereunder will be free of defects in material and workmanship for one year from the date of purchase. The Company within said period shall at its option, either repair or replace free of charge, any product or part thereof found, upon the Company's inspection, to be so defective, and will return the repaired or replaced product to the purchaser at Company's expense. For warranty service and shipping instructions contact 1-800-528-4454. Devices must be sent to the Company at owner's expense and be accompanied with statement of defect and proof of purchase. This warranty is conditioned on the following: 1). The Company must be notified within the period of the warranty from the date of purchase and have been given the opportunity of inspection by return of any alleged defective product free and clear of all liens and encumbrances to the Company or its distributor; and 2). The product must not have been abused, misused or improperly maintained and/or repaired during such period; and 3). such defect has not been caused by corrosion or exposure to other than ordinary wear and tear. **THE COMPANY MAKES NO OTHER WARRANTY OR REPRESENTATION OF ANY KIND WHATSOEVER EXPRESS OR IMPLIED, AND ALL IMPLIED WARRANTIES INCLUDING ANY WARRANTY OF MERCHANTABILITY OR FITNESS FOR A PARTICULAR PURPOSE ARE HEREBY DISCLAIMED.** The Company's maximum liability hereunder is limited to the purchased price of the product. In no event shall the Company be liable for any consequential, indirect, incidental or special damages of any nature arising from the sale or use of the product, whether based in contract, tort, strict liability or otherwise. Note: Some states do not allow limitations on incidental or consequential damages or how long an implied warranty lasts so that the above limitations may not fully apply. This warranty gives specific legal rights and you may also have other rights which may vary from state to state.

**Linear**

Stanley® is a registered trademark of The Stanley Works